



# e x i s s

Luxury interior design material

Sustainable

Durable

Luxurious

Innovative

**FUSED BAMBOO FOR EXTERIOR USE**

DECKING / CLADDING / SOFFIT / FENCE / LUMBER & PANEL

exiss  
Luxury interior design material





## CONTENT

<i>Fused Bamboo</i> .....	08
<i>Decking</i> .....	14
<i>Cladding</i> .....	16
<i>Soffit</i> .....	18
<i>Lumber &amp; Panel</i> .....	20
<i>Project</i> .....	24



· Fused Bamboo 10,000,000 M<sup>2</sup> has been installed all over the world  
· Next Generation of Hard Wood for Exterior Use  
· From Natural to Natural



## Fused Bamboo for Exterior Use



**Decking**  
*Reversible face  
Structural T&G end match*



**Cladding**  
*Simple, easy hidden fastener system  
Modular T&G end match installation*



**Soffit**  
*Easy hidden fastener system  
Structural T&G end match*



**Lumber and Panels**  
*Wide range of usage  
Flexible for customized production*





### Technology Principle



**XTR**  
*exiss XTR patented fusion process extracts the sugars and starches from the bamboo fibers and replaces it with phenolic resins. Then the impregnated fibers are compressed to create a very hard, dense and durable Fused Bamboo\* that prevents bacteria, fungus and other micro-organisms from attacking exiss XTR.*

**CTECH**  
*exiss CTECH is crystalized the fibers with Ceramix® particles, impregnated it with phenolic resin(the same resin found in bowling balls),then compressed to form Fused Bamboo. Because Fused Bamboo is now fully impregnated with Ceramix® particles that crystalizes the nutrients from attracting bacteria, fungus, molds or insects, the fibers does not rot under exposed environments.*

### Fused Bamboo vs Other Exterior Materials

Competitive Material	CTECH	XTR	Ipe	Balau(Bangkirai)	Teak	Meranti Batu	Western Red Cedar
Density(kg/m3)	1,200	1,100	1,060	850	655	480	340
Stiffness MOE(MPa)	16,700	14,490	22,070	16,950	11,280	11,390	7,660
Janka Hardness(N)	17,659	16,992	15,620	7,120	4,740	2,460	1,560
Durability(Class)	1	1	1-2	2	1-3	3-4	2

### The Feature of Fused Bamboo



#### Environment Friendly

Ready for harvest after 4-6 years (compared to up to 100 years for hardwood species)-no deforestation



#### Mould Resistance

Class 0 [DIN EN ISO 846: 1997-10] [DIN EN 152: 2011]



#### Fire Resistance

Class A-ASTM E84 BFl-s1-EN 13501-1 BAL 29-AS 1530.8.1-2007



#### Termite Resistance

Retikuli termites santonensis DC (Durable) [EN 117] Class 1-AS 5604 (2005)



#### Hard & Durable

Brinell > 9.5kg/mm2 [EN1534], harder than any other hardwood. Durability: Class 1 [CEN/TS 15083-1:2005][EN 350: 2016]



#### Warranty

Applicable Residential and Commercial Warranty

### The Process of Fused Bamboo



Decking



Cladding



Soffit



Lumber & Panel

## DECKING

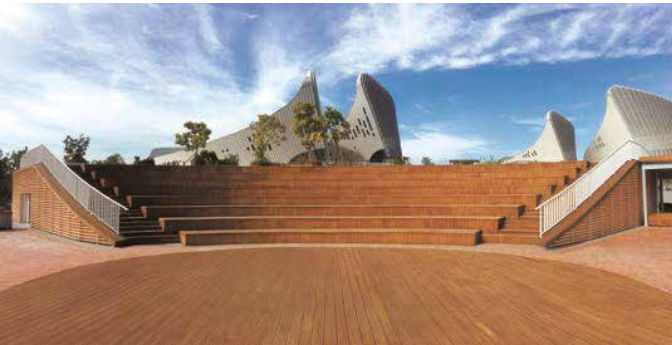

*exiss XTR & exiss CTECH Decking are the superior choice for all exterior decking applications and has been used worldwide in many commercial and residential projects. Only two decking profiles are needed for your exterior decking application. A single grooved (G1) plank used as starter and ending plank and the G2 for the deck itself. All our deck planks also include our exclusive tongue & grooved end matched system to attach the planks seamlessly together.*

### Feature



### Specification

XTR Decking	CTECH Decking	Size (mm)	XTR Decking	CTECH Decking	Size (mm)
XD20-SG2-5TG-PSR	ED20-SG2-5TG-PSR	T20 * W137 * L1850	XD20-MG2-5TG-PSR	ED20-MG2-5TG-PSR	T20 * W155 * L1850
XD20-SG1-5TG-PSR	ED20-SG1-5TG-PSR	T20 * W137 * L1850	XD20-WG2-5TG-PSR	ED20-WG2-5TG-PSR	T20 * W178 * L1850
XD20-SG2-5TG-PSV	ED20-SG2-5TG-PSV	T20 * W137 * L1850	XD40-SG0-5TG-PSV	ED40-SG0-5TG-PSR	T20 * W137 * L1850
XD20-SG1-5TG-PSV	ED20-SG1-5TG-PSV	T20 * W137 * L1850			

## Installation

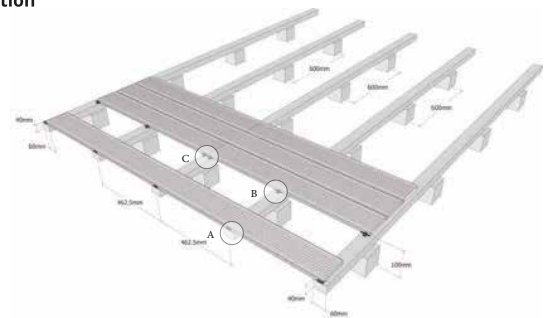

A

B

C

### Option1: Clip Installation

- Determine the surface side of the boards (reeded or flat surface).
- Use fasteners or other suitable fasteners in the following sequence.
- Press fastener in the groove of one decking board.
- Tighten the screw in the fastener and the sub beam.
- Use approx. 20/17/14 fasteners per m<sup>2</sup>, this is depending on the type or board 137/155/178mm wide. When the tongue and groove are connected on the sub beam use 2 fasteners, 1 for every board.

*Step 6. Only use the included stainless steel decking screws (4.5x30mm).*

### Option2: Screw down installation

- Determine the surface side of the boards (reeded or flat surface).
- Pre-drill the screw holes 20mm from the side of the board. Be sure to pre-drill with a large enough drill to avoid cracking of the decking.
- Always screw both sides (left and right) of the board.
- Use stainless steel decking screws (5x50mm).

## Installation Accessories

	Clips Code	Size	Photos		Screw Code	Size	Photos
	Clips	I-Clips (DC-02)	28x25x12			Screw	DS-01
B-Clips (DC-04)		40x15x10		DS-02	M6x24.5		
S-Clips (DC-06)		28x25x12		DS-04	M6x29		

## CLADDING



exissXTR



exissCTECH



exiss XTR & exiss CTECH Cladding is the great choice in commercial exterior siding, where it ages naturally like wood. Our unique sheathing system with FasTrak offers the most appealing looking rain screen and cladding siding solution available. It reduces wastage and speeds up installation by 50%.

### Feature



End Matched



Match Installation



SHIPLAP



Hard & Durable



Fire Resistance



Stable & Precise



Termite Resistance



Mould Resistance

### Specification

exissXTR Cladding	exissCTECH Cladding	Size (mm)	exissXTR Cladding	exissCTECH Cladding	Size (mm)
XS18-MSL-5TG-PSS	ES18-MSL-5TG-PSS	T18 * W137 * L1860	XS12-100-6FT-PSS	ES12-100-6FT-PSS	T12 * W100 * L 1860
XS18-WSL-5TG-PSS	ES18-WSL-5TG-PSS	T18 * W178 * L1860			

## Installation

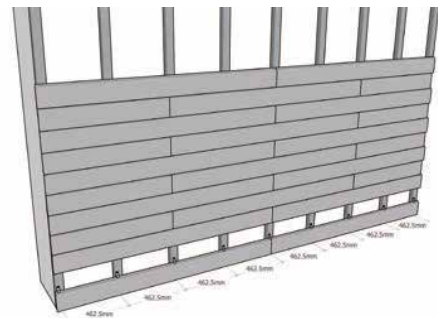

First Row



Second Row

### Step 1. Levelling first row of fasteners.

- Start with the lowest row of fasteners and make sure they are placed fully level (using a spirit level).

W

### Step 2. Install first row of boards W

- Holding the first boards level, slide the lip of the groove on the lower edge behind the tabs on the fasteners.

- Make sure that the fasteners engage deeply enough in the groove so that the boards lay level. Tapping the boards should be done carefully, preferably with a rubber mallet.

- We advise always fixing the end (end joints) of the boards on a batten/ beam, using 2 fasteners.

### Step 3. Second row of fasteners

- Install the second row of fasteners, pushing them down on the top edge of the first row of boards.

### Step 4. Install second row of boards.

Step 5. Continue with the rest.

- Continue to install the cladding boards in this way to cover the full surface. Make sure you keep the fasteners level and make sure enough ventilation space (5-10 mm) is kept on the edge.

## Installation Accessories

Clips	Clips Code	Size	Photos	Screw	Screw Code	Size	Photos
	Clip [CC-18]	42.5x19x15			CS-01	M11x30	
Clip [CC-12]	40.5x24.5x8		DS-01	M6x30			



## SOFFIT



exissXTR



exissCTECH



*exiss XTR & exiss CTECH Soffit, Deck Skirting and Wainscoting are Pre-primed and specifically designed for interior and exterior use with no leaching and zero VOC. All Fused Bamboo are bft rated. exiss CTECH soffit, deck skirting and wainscoting are ideal for creating an elegance lasting beauty environment.*

### Feature



End Matched



Fire Resistance

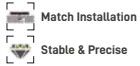

Match Installation



Stable & Precise



SHIPLAP



Termite Resistance



Hard & Durable



Mould Resistance

### Specification

exiss XTR Soffit	exiss CTECH Soffit	Size (mm)
XSO12-100-STG-P55	ESO12-100-STG-P55	T12 * W100 * L1850

## Installation

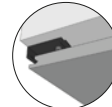
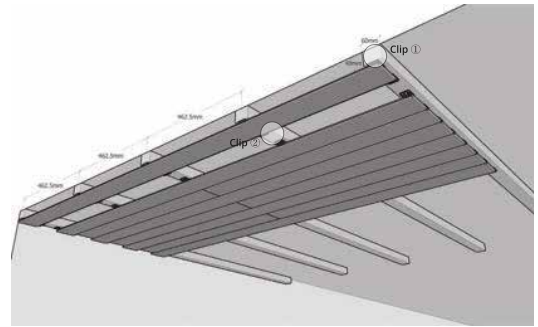

Clip ①



Clip ②

**Step 1:** Make sure the soffit is the surface. Use the soffit clip.

**Step 2:** Use the starter clip ① for the first board. Use 1 screw per starter clip.

**Step 3:** Use the soffit clip ② to install the following soffit boards, screw down the nail to contact the joint and clips, use 2 screws per field clip for soffit.

**Step 5:** Use approx. 16 fasteners per m<sup>2</sup>, each joint should use the clips.

**Step 6:** For applications exposed to salt air, near large bodies of water, swimming pools or other areas where corrosion is more likely to occur, always use Grade 316 stainless steel screws.

## Installation Accessories

Clips	Clips Code	Size	Photos	Screw	Screw Code	Size	Photos
	Clip S0F-1	32x32x10.6			SS-01	M8x28	
Clip S0F-2	32x25x11.5						

## LUMBER&PANEL&FENCE



exissXTR



exissCTECH



*exiss XTR & exiss CTECH Lumber and Panels are to be considered like unfinished lumber; it is S2S+RE2 (sides need to be planed). The material is not pre-primed so the user can finish it as they choose. Both lumbars and panels come oversized to trim in two different thickness: 20mm and 40mm.  
exiss XTR & exissCTECH bamboo panels are ideal for creating outdoor furnishings for years of lasting beauty.  
exiss XTR & exiss CTECH Fence is Pre-primed and specifically designed for gallery frame, Pergola barrier, outdoor furnishings, signs and so on.*

### Feature

-  Hard & Durable
-  Fire Resistance
-  Stable & Precise
-  Termite Resistance
-  Mould Resistance
-  Wide range of usage
-  Flexible for customized production

### Specification

XTR Lumber	CTECH Lumber	Size (mm)
XL20 -205-6 FT-UAC	EL 20-205-6 FT-PAC	T20 * W205 * L1860
XL40 -152-6 FT-UAC	EL 40 -152-6 FT-PAC	T40 * W152 * L1860
XP20 -625-6 FT-UAC	/	T20 * W625 * L1860
XP40 -625-6 FT-UAC	/	T40 * W625 * L1860
XF30 -65-6 FT-PSS	EF 30-65-6 FT-PSS	T30 * W65 * L1860
XF30 -100-6 FT-PSS	EF 30-100-6 FT-PSS	T30 * W100 * L1860



## Color Fading & Maintenance

Fused Bamboo (DassoXTR and exiss CTECH) are natural product, its appearance may vary in grains and colors. When exposed under the natural sunlight over time, the appearance and color may change depending on the extent of UV light exposed to the material. The XTR boards originally have a dark brown color and the CTECH in Cognac, both will lighten up over several weeks or months. The board's color without regular maintenance will eventually grey out to a nice silver patina just like any hardwood exposed to sunlight. If a brown color is preferred, maintenance should be done with an exterior penetrating oil. Stains could be added to the penetrating oil to achieve a desired color of the finish product.



## Normal Phenomena

Checks and cracks on the surface and on the ends of the boards can arise from the different drying characteristics of the surface and cross-cut ends. This does not affect the structural soundness of the boards.

## Project Reference - Tourism College of Zhejiang ( Qiandao Lake Campus )

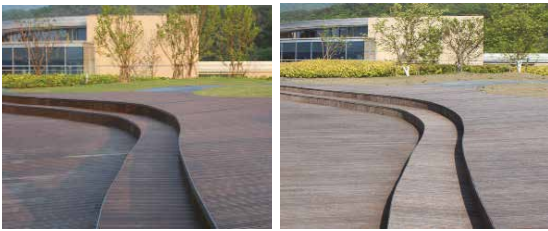

Installed in 2013

Revisited in 2019

## WARRANTY

exiss XTR and exiss CTECH offers a 25 years (residential application)/ 10 years (commercial application) limited warranty against material defects in workmanship and warrant that the material will not suffer structural damage due to rot, decay, or termites for that period of time, as long as it has been installed and maintained according to our guidelines.

### SCOPE

- The outdoor board is a natural forest product, which varies in color, grain and appearance. Color changes over time depending on the maintenance schedule. Color change can not be a reason to make a claim.
- This warranty does not cover damage caused by misuse, accidents, insect infestation, force majeure and damage caused by other, in normal residential unusual, circumstances.
- Also not covered are purely visual impairments such as imprints, joints, discoloration by light, seasonal climate-related deformation or wear of the surface coating. Damage resulting from improper installation, maintenance, cleaning or maintenance of the surface coating, mechanical or chemical damage are also excluded from this warranty.
- This warranty statement supersedes all previous statements; the granting of the manufacturer's warranty applies only to the current version.
- Cracks on the surface and on the end of the boards can arise from the different drying characteristics of the surface and cross cut ends. This phenomenon is normal for most wood species and can not be a reason to make a claim.
- The surface sides of the boards will get rougher and will splinter over time as a result of constant shrink and swell of the boards due to dry and wet climate periods. This phenomenon is normal for most wood species and can not be a reason to make a claim.
- Dimensional change or cupping of the boards can occur after installation. This phenomenon is normal for most wood species and can not be a reason to make a claim.
- The guarantee extends to A-grade products only.
- The guarantee applies only to the original purchaser.

### Warranty Conditions

To be able to make use of the warranty the decking must be installed according to the installation instructions. Please read our installation instructions carefully, before installing the floor. No claims can be accepted in case of improper installation!

- This warranty applies in addition to the normal legal rights of the buyer, including the rights of the buyer against the seller.
- If a claim is granted before installing the material, faulty planks are replaced free of charge. No claims can be accepted after installing the material if the buyer could have detected the defects before installation. This warranty does not cover damage that was caused by Third parties (eg transport damage).
- If defects occur after installation, exiss reserves the right to either repair the defect or to offer material free of charge to the buyer. If the defective product is no longer in the product range, an equivalent from the current range will be supplied.
- A claim does not lead to an extension of the warranty period.
- The cost for the replacement of material and other charges are not included in the warranty.

### Settlement of the guarantee

The claim must be made in writing, within 30 days, to the exiss dealer/seller, a exiss subsidiary or directly to exiss headquarter.

exiss reserves the right to check the claimed damage.





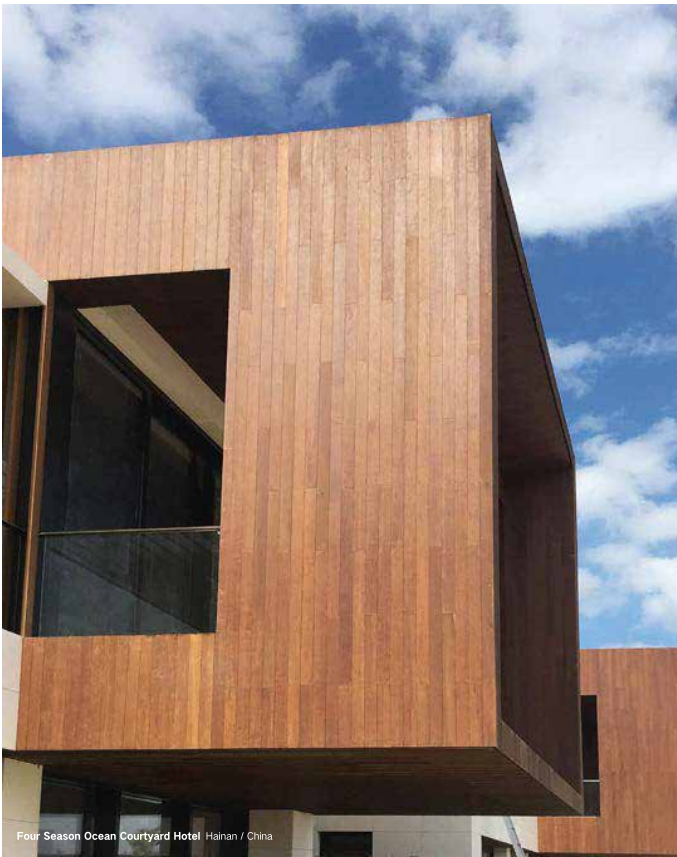





Atlantis Sanya Hainan / China



NanXun Urban Planning Exhibition Center Zhejiang / China

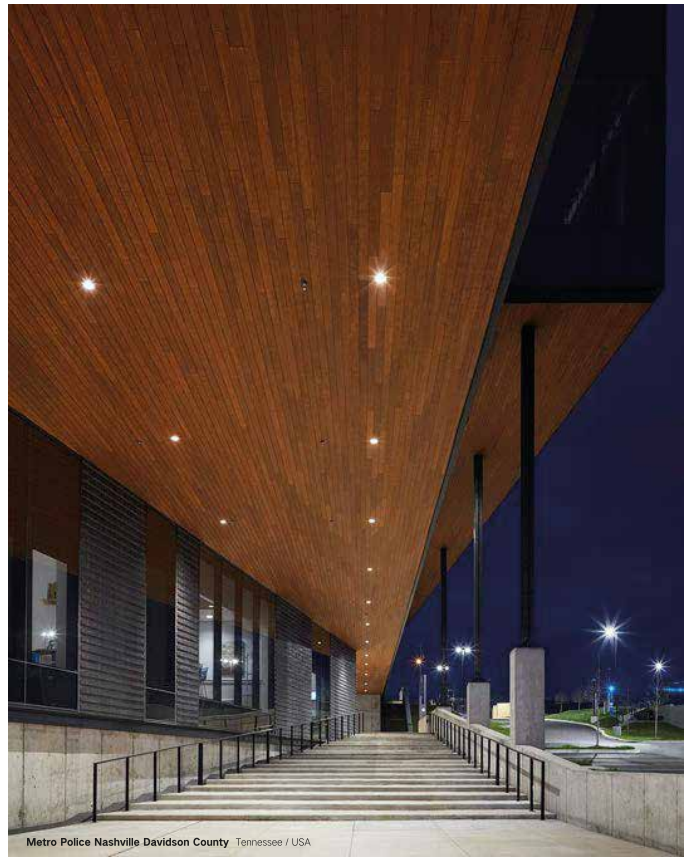

Metro Police Nashville Davidson County Tennessee / USA





Changchun Culture of Water Ecology Park, Jilin / China



Tsingpu Yangzhou Retreat, Sichuan / China

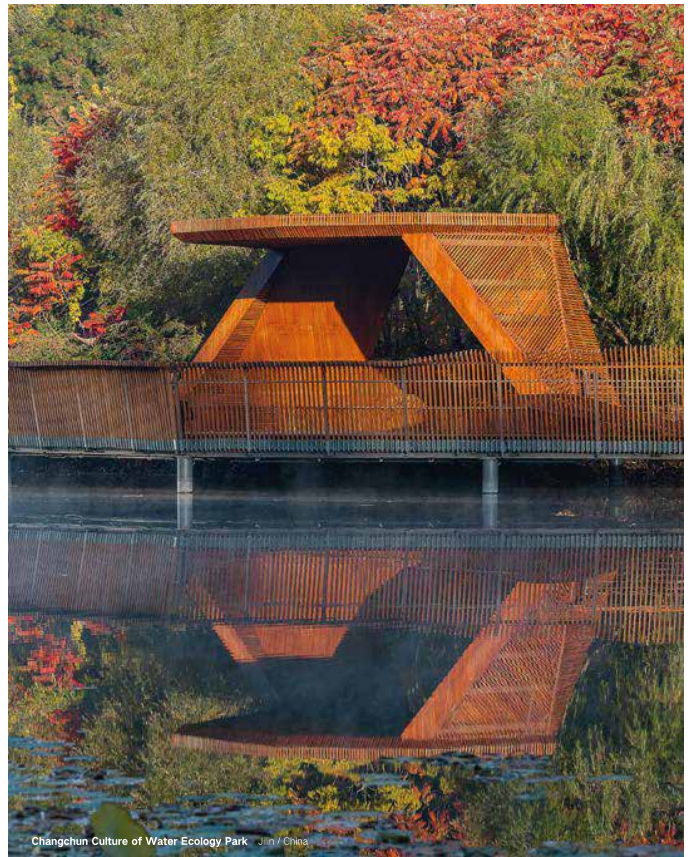

Changchun Culture of Water Ecology Park, Jilin / China



Hotel in German



Vanke Metropolis in Beijing



Qiandao Lake Pearl Square



Tsingpu Yangzhou Retreat



Fifth Park of Shanghai Vanke Blue Mountain



Reconstruction of Jiin Waterworks



Jiezi Ancient Town Meiyi Square



Atlantis Sanya



Park in Taiwan



Vanke Center Shenzhen



Changchun Culture of Water Ecology Park



Kunming Innhouse



Embassy of Switzerland in China



Wuxi Yangshan Geological Museum



Tourism College of Zhejiang (Qiandao Lake Campus)



Metro Police Nashville Davidson County



Tianjin Eco City-Jinlu



Private Villa in Sanya



HongKong-Zuhai-Macao Bridge



Private Villa in Morocco



Chongzhou Ancient Town in Chengdu



Wuzhen Graceland



Changchun Park Landscape



Yitong River Landscape

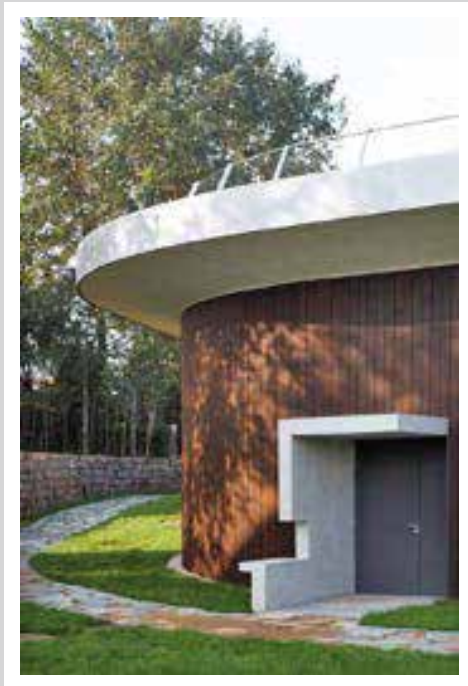

## Contact

ارتباط با ما **US**

No24,7th Abkooh,  
Poordad Ave, Aghaee  
Ave, Niavaran St,  
Tehran, Iran

☎ 021 22 87 10 57-8

☎ 0912 19 55 802

☎ 0920 39 55 802

✉ exiss.co@gmail.com

🌐 www.exissco.com

📷 exiss\_company

📺 exiss.online